



 **DAIMIOS**  
INFRASTRUCTURE  
PLOT | FLAT | FARMHOUSE | VILLA



“Find Peace, Live Naturally.”

## About us..

Experience the perfect harmony of rustic charm and modern elegance at our exquisitely crafted luxury mud house. Designed using sustainable materials and traditional techniques, this eco-conscious retreat redefines comfort and sophistication.

Each element of the home is thoughtfully curated—combining the raw warmth of natural architecture with contemporary aesthetics, open-plan interiors, and high-end finishes. Enjoy spacious living, premium amenities, and a serene environment that nurtures peace and privacy.

Nestled in a scenic, secluded location, this mud house is an ideal escape for those seeking tranquility and nature’s embrace—without compromising on style, elegance, or comfort.



## Facilities Mud House

- 1008 sq. yd Mud House
- 900 sq ft 2 BHK House.
- Deck Area • 15'x25' Natural Pond
- 10'x10' Machan
- 10'x14' Guard Room With Washroom
- Developed Garden • Developed Covered Boundary
- 20'x45' RC With Tile Car Parking
- Developed Kitchen Garden
- 3KV Solar
- 1HP Submersible
- 4Side Garden Solar Light
- Out Side Plantation
- Entry Gate with MS Nameplate

Luxury

**MUDHOUSE**

EVER



## Facilities Farm House

- 1008 sq. yd. FarmHouse
- 900 sq ft 2 BHK House.
- Deck Area•15'x25' Swimming Pool
- 10'x10' Gazebo
- 10'x14' Guard Room With Washroom & Pantry
- Developed Garden
- Developed Covered Boundary
- 20'x45' RC With Tile Car Parking
- 3KV Solar
- 1HP Submersible
- Outside Plantation
- Entry Gate with MS Nameplate

Luxury

**FARM HOUSE**



# 3D MODELING



# SITE PLAN

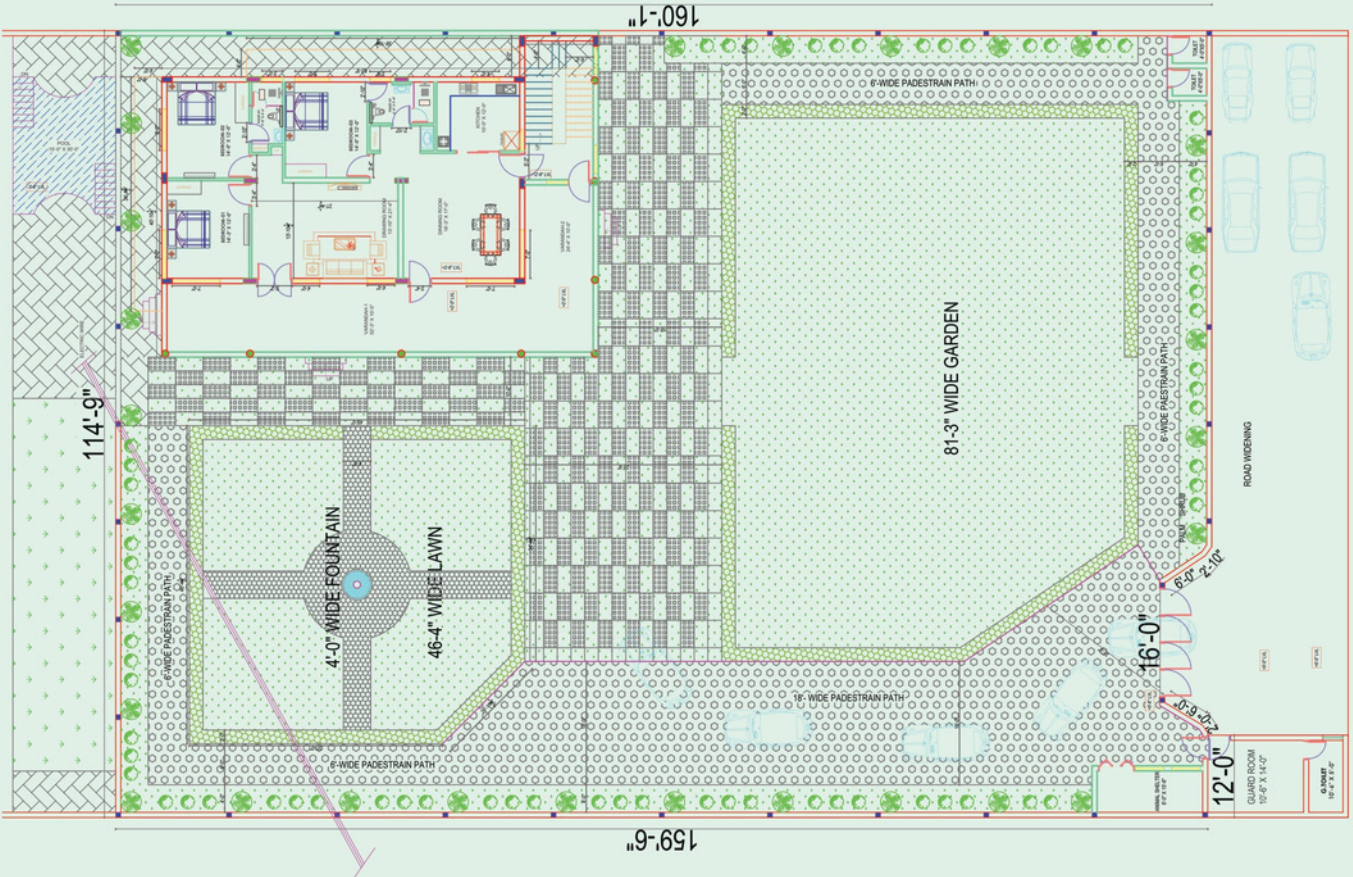

THE NRI LUXURY FARMS  
CHECKED BY  
DRAWN DATE  
DATE BY

DATE BY	DATE BY	DATE BY	DATE BY
15/07/2014	15/07/2014	15/07/2014	15/07/2014
15/07/2014	15/07/2014	15/07/2014	15/07/2014
15/07/2014	15/07/2014	15/07/2014	15/07/2014



Block	Lot No.	Area (sq. m)	Area (sq. yds)
A BLOCK	AP0-1	1457.77	347.99
	AP0-2	1500.00	349.00
	AP0-3	1500.00	349.00
	AP0-4	1500.00	349.00
	AP0-5	1500.00	349.00
	AP0-6	1500.00	349.00
	AP0-7	1500.00	349.00
	AP0-8	1500.00	349.00
	AP0-9	1500.00	349.00
	AP0-10	1500.00	349.00
B BLOCK	AP0-11	1500.00	349.00
	AP0-12	1500.00	349.00
	AP0-13	1500.00	349.00
	AP0-14	1500.00	349.00
	AP0-15	1500.00	349.00
	AP0-16	1500.00	349.00
	AP0-17	1500.00	349.00
	AP0-18	1500.00	349.00
	AP0-19	1500.00	349.00
	AP0-20	1500.00	349.00
C BLOCK	AP0-21	1500.00	349.00
	AP0-22	1500.00	349.00
	AP0-23	1500.00	349.00
	AP0-24	1500.00	349.00
	AP0-25	1500.00	349.00
	AP0-26	1500.00	349.00
	AP0-27	1500.00	349.00
	AP0-28	1500.00	349.00
	AP0-29	1500.00	349.00
	AP0-30	1500.00	349.00
D BLOCK	AP0-31	1500.00	349.00
	AP0-32	1500.00	349.00
	AP0-33	1500.00	349.00
	AP0-34	1500.00	349.00
	AP0-35	1500.00	349.00
	AP0-36	1500.00	349.00
	AP0-37	1500.00	349.00
	AP0-38	1500.00	349.00
	AP0-39	1500.00	349.00
	AP0-40	1500.00	349.00
E BLOCK	AP0-41	1500.00	349.00
	AP0-42	1500.00	349.00
	AP0-43	1500.00	349.00
	AP0-44	1500.00	349.00
	AP0-45	1500.00	349.00
	AP0-46	1500.00	349.00
	AP0-47	1500.00	349.00
	AP0-48	1500.00	349.00
	AP0-49	1500.00	349.00
	AP0-50	1500.00	349.00
F BLOCK	AP0-51	1500.00	349.00
	AP0-52	1500.00	349.00
	AP0-53	1500.00	349.00
	AP0-54	1500.00	349.00
	AP0-55	1500.00	349.00
	AP0-56	1500.00	349.00
	AP0-57	1500.00	349.00
	AP0-58	1500.00	349.00
	AP0-59	1500.00	349.00
	AP0-60	1500.00	349.00
G BLOCK	AP0-61	1500.00	349.00
	AP0-62	1500.00	349.00
	AP0-63	1500.00	349.00
	AP0-64	1500.00	349.00
	AP0-65	1500.00	349.00
	AP0-66	1500.00	349.00
	AP0-67	1500.00	349.00
	AP0-68	1500.00	349.00
	AP0-69	1500.00	349.00
	AP0-70	1500.00	349.00

Block	Lot No.	Area (sq. m)	Area (sq. yds)
E BLOCK	AP0-1	1500.00	349.00
	AP0-2	1500.00	349.00
	AP0-3	1500.00	349.00
	AP0-4	1500.00	349.00
	AP0-5	1500.00	349.00
	AP0-6	1500.00	349.00
	AP0-7	1500.00	349.00
	AP0-8	1500.00	349.00
	AP0-9	1500.00	349.00
	AP0-10	1500.00	349.00
F BLOCK	AP0-11	1500.00	349.00
	AP0-12	1500.00	349.00
	AP0-13	1500.00	349.00
	AP0-14	1500.00	349.00
	AP0-15	1500.00	349.00
	AP0-16	1500.00	349.00
	AP0-17	1500.00	349.00
	AP0-18	1500.00	349.00
	AP0-19	1500.00	349.00
	AP0-20	1500.00	349.00
G BLOCK	AP0-21	1500.00	349.00
	AP0-22	1500.00	349.00
	AP0-23	1500.00	349.00
	AP0-24	1500.00	349.00
	AP0-25	1500.00	349.00
	AP0-26	1500.00	349.00
	AP0-27	1500.00	349.00
	AP0-28	1500.00	349.00
	AP0-29	1500.00	349.00
	AP0-30	1500.00	349.00



## Noida International Airport



## Key Landmarks Near by :

- 1 . World 4th Biggest Airport (Noida International)
- 2 . Film City Sec - 21 (1000 acre)
- 3 . Buddha International Circuit (F1 Track)
- 4 . Sport City
- 5 . Logistics Hub
- 6 . Institutional City
- 7 . Industrial Hub
- 8 . Rapid Metro
- 9 . POD Taxi (Pari Chowk to Airport)
- 10 . Metro Coach Factory Sec 22
- 11 . Vivo / Lava Company Sec 24
- 12 . Airplane Aviation Hub
- 13 . Toy City Sec 33
- 14 . Integrated Cargo Hub
- 15 . Largest Expressway Connectivity



**Noida Golf Course**



## **Amenities :**

Golf Course

Cricket Ground

Wellness Centre

Club House

Horse Riding Ground

Mandir Pitambra Maai & Khatu Shyam Ji

Children's Park

Banquet Hall

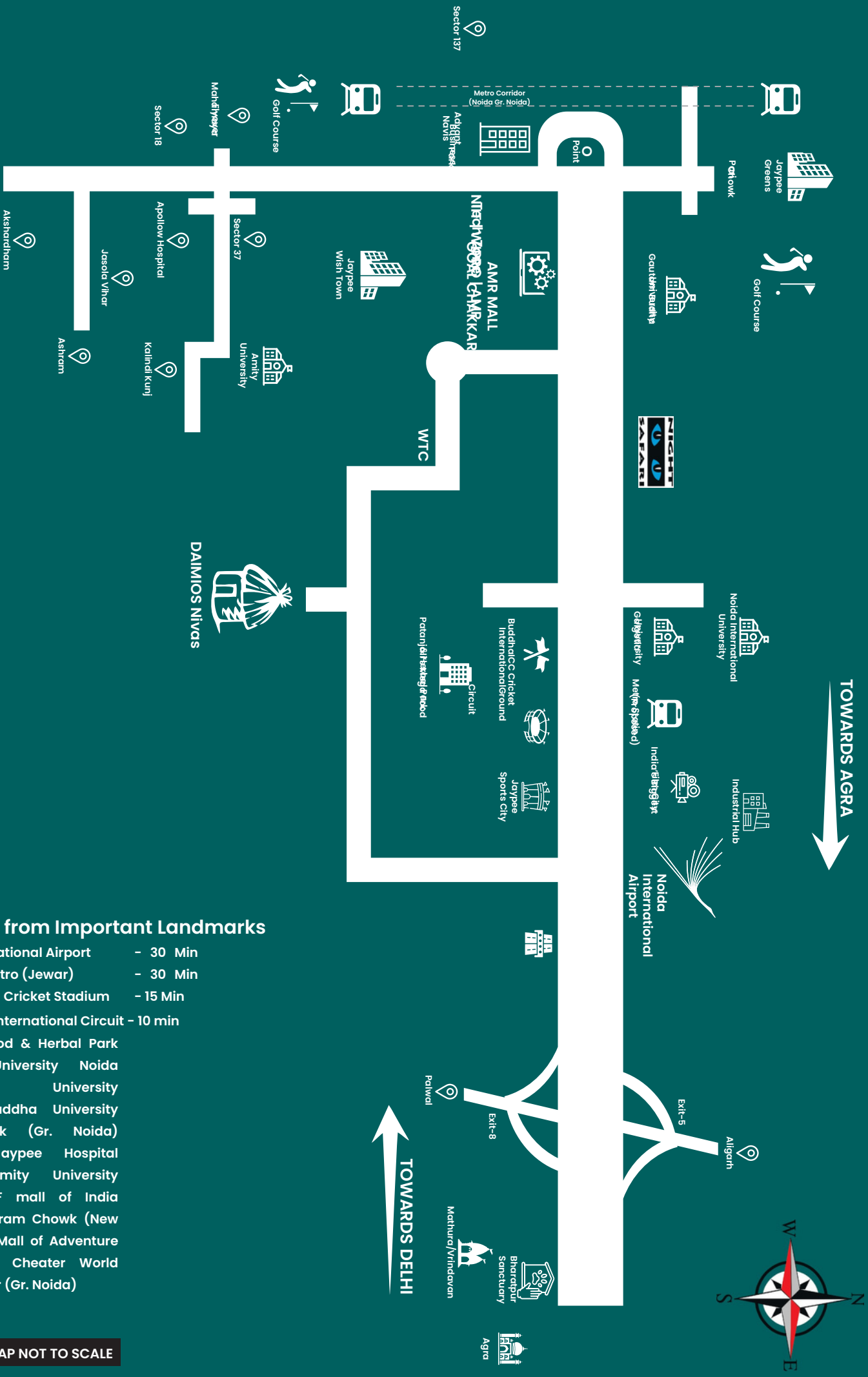

### Distance from Important Landmarks

- Noida International Airport - 30 Min
- Proposed Metro (Jewar) - 30 Min
- International Cricket Stadium - 15 Min
- F-1 Buddha International Circuit - 10 min
- Patanjali Food & Herbal Park - 10 min
- Amity University Noida - 10 min
- International University - 10 min
- Buddha University - 10 min
- Chowk (Gr. Noida) - 10 min
- Jaypee Hospital - 10 min
- Amity University - 10 min
- DLF mall of India - 10 min
- Ashram Chowk (New Delhi) - 10 min
- AMR Mall of Adventure - 10 min
- Noida Cheater World Trade Center (Gr. Noida) - 5 Min

MAP NOT TO SCALE